



**BELGRADE
FAIR**

**THE PLACE WHERE
IDEAS UNITED PEOPLE**





THE PLACE WHERE IDEAS UNITED PEOPLE

The first Belgrade Fair was officially opened on September 11, 1937 and very quickly became **the economic center of the region.**





The first post-war trade fair - the International Fair of Technic, opened its gates on August 23, 1957, and **it will go down in history as the fact that 1,150,000 people visited it.**

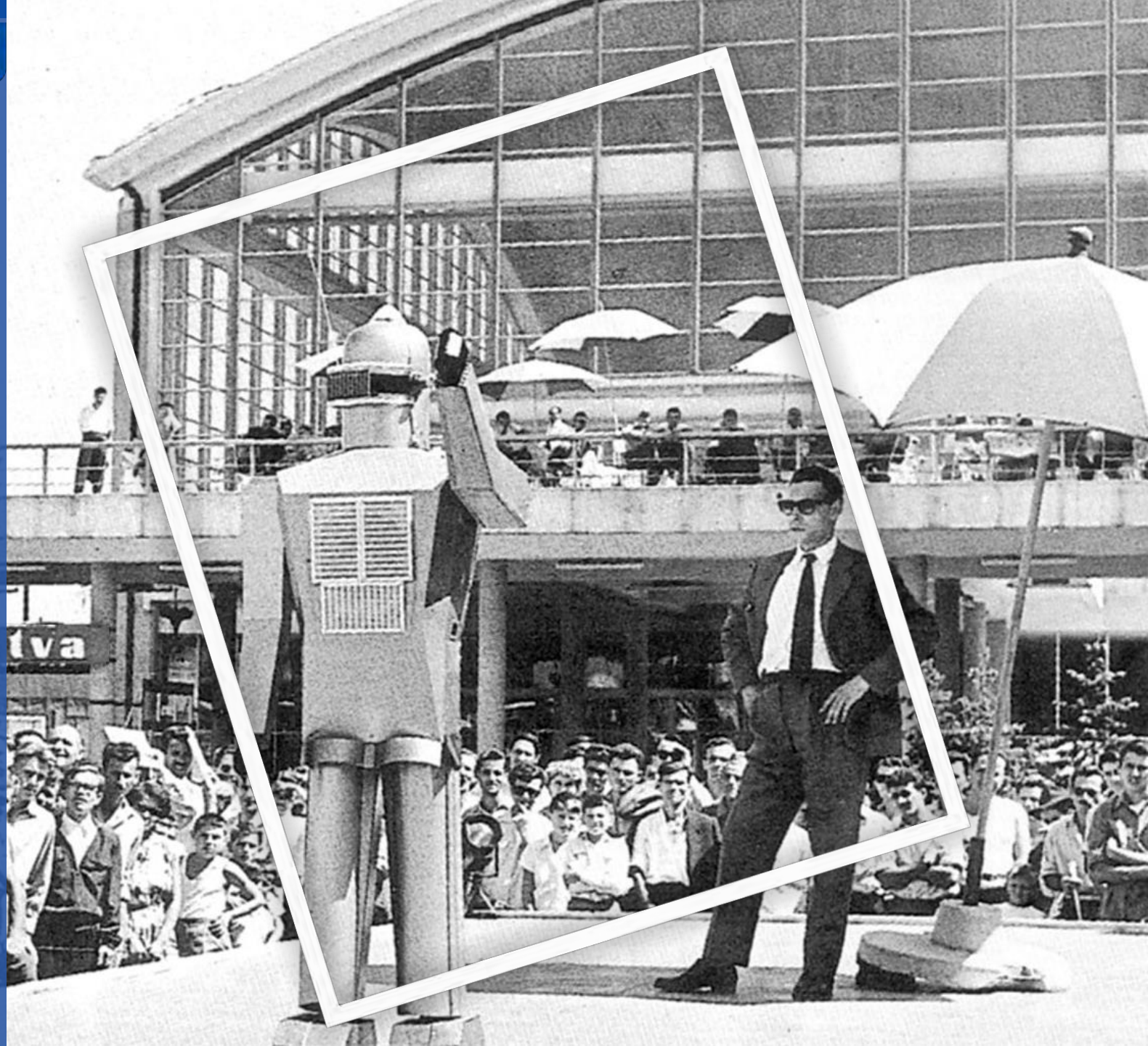



The Belgrade Fair is the largest fair institution in Serbia. With its capacities is able to provide the most diverse services to interested business partners.

Follow the champions. >>>





ORGANIZATION OF

- EVENTS
- CONFERENCES
- EXIBITIONS
- CONCERTS





Belgrade Fair is a member of the Central European Fair Alliance (CEFA).

The sign of the International Fair Union – UFI is carried by six large events – the Building, Technical, Furniture, Book, Tourism and Energy Fairs, and Motor Show is a member of the International Organization of Motor Vehicle Manufacturers – OICA.





Commitment to improvement and modernization of exhibition halls, and also to communication and building partnership relations with exhibitors and visitors, is the Belgrade Fair's permanent business orientation.

Successful business is made by people, and its foundations are built of professional cooperation and trust, the values Belgrade Fair supports from the very beginning.





We connect people and markets. Tradition and innovation. Ideas and technologies. Trends and industries. We are open for new business models, projects and cooperation.

We create – We connect – We build

The Belgrade Fair is not only halls and exhibition space. The Belgrade Fair are also the services we offer and the events we have been successfully organizing for decades.





The Belgrade fair complex includes 14 modern halls located on the right bank of the Sava river, and is one of the recognizable symbols of Belgrade.

It covers a total area of **24 hectares**, with the **exhibition space in all halls of approx. 100,000m²**. The **open exhibition space** covers the area of approx. **35,000m²**.





Parking lot for 1700 cars

Fully automated and connected
Electronic car and pedestrian
entrance





HALL 3





HALL 3

The Hall 3 is rectangular in shape, with arched walls, has got two levels and a gallery, the basement section of which is used for the warehouse and auxiliary facilities, whereas the ground floor and gallery for exhibiting. The hall is air conditioned and connected to halls 3A and 2B/2C. The total area is 8,109 sq. m., of which the exhibiting space of 4,438 sq. m.

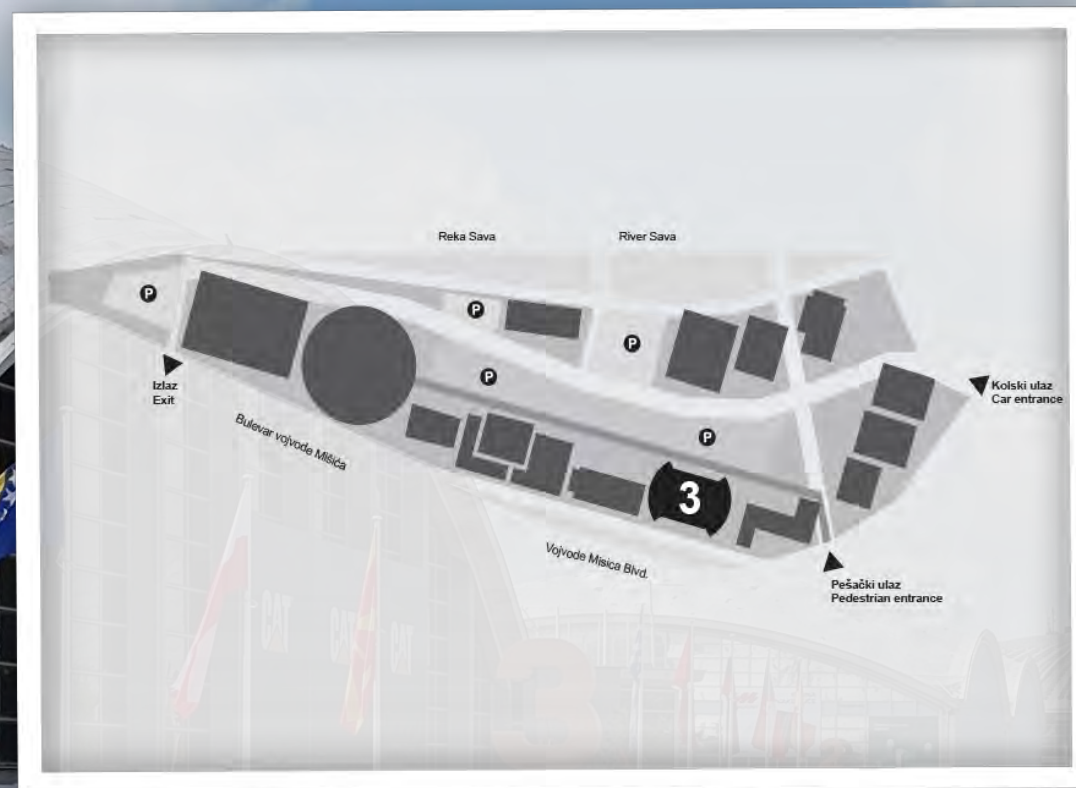



HALL 3

Length - 50.76 m

Width - 77.8 m

Height - 20.3 m

Ground Floor Area - 3,510 sq. m

Gallery Area - 928 sq. m

Pedestrian Entrances/Exits - 2

Cargo Entrances - 3 (3.7 x 3.85 m;
4.7 x 4.3 m; 5 x 4.2 m)

Electricity - 220V/50Hz

Internet - Optical LAN
Network/Up to 1/Gbs

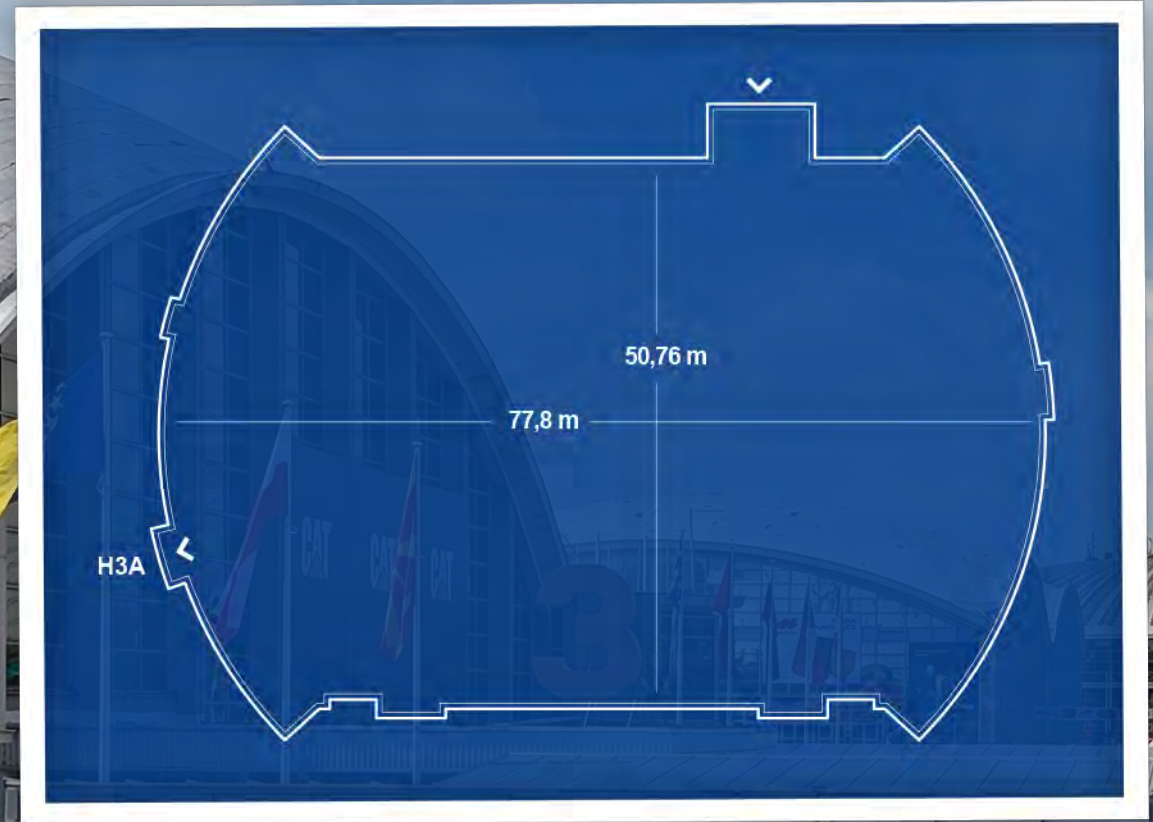



HALL 3A





HALL 3A

The **Hall 3A** is rectangular in shape and it connected by terraces to the Halls 2 and 3. The hall has got two levels having the total area of **2,190 sq. m.**, of which **1,468 sq. m.** is used as the exhibiting space and the rest are offices, warehouse and auxiliary facilities. The hall is air conditioned.

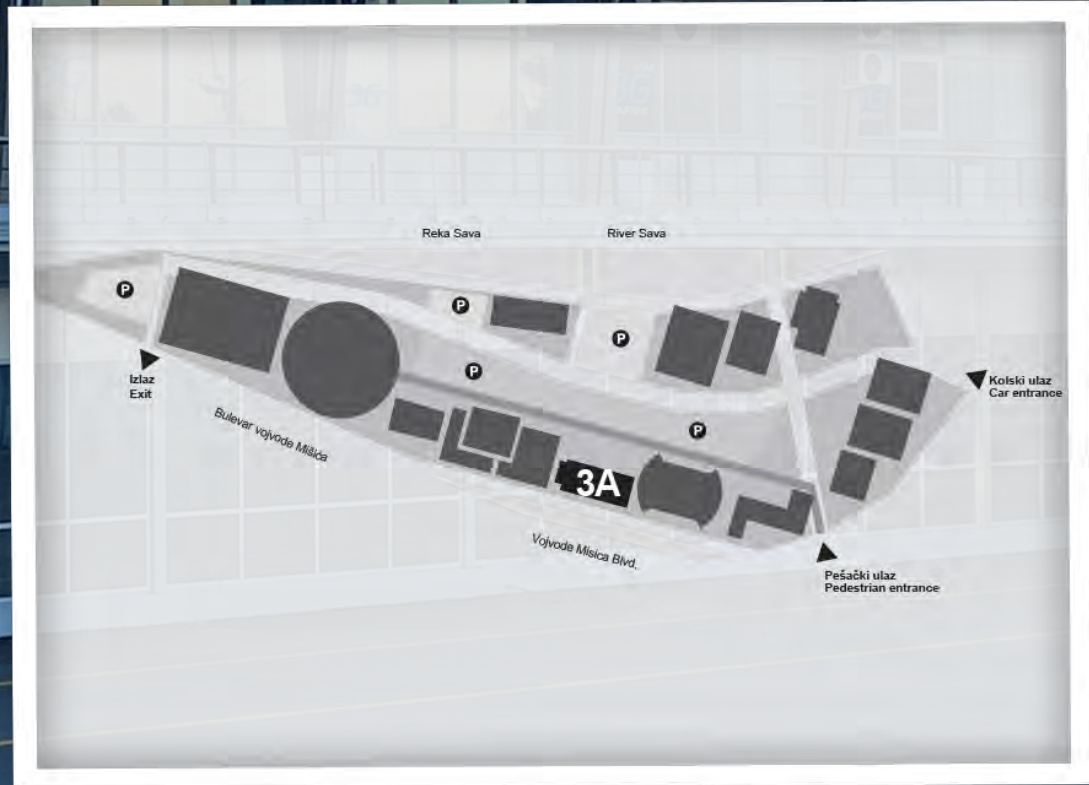



HALA 3A

Length - 17.77 m

Width - 56.87 m

Height - 4.15 m max.

Ground Floor Area - 1,018 sq. m

Pedestrian Entrances/Exits - 2

Cargo Entrances - 2 (5.65 x 3.85 m; 5,3 x 4.05 m)

Electricity - 220V/50Hz

Internet - Optical LAN Network/Up to 1/1Gbs

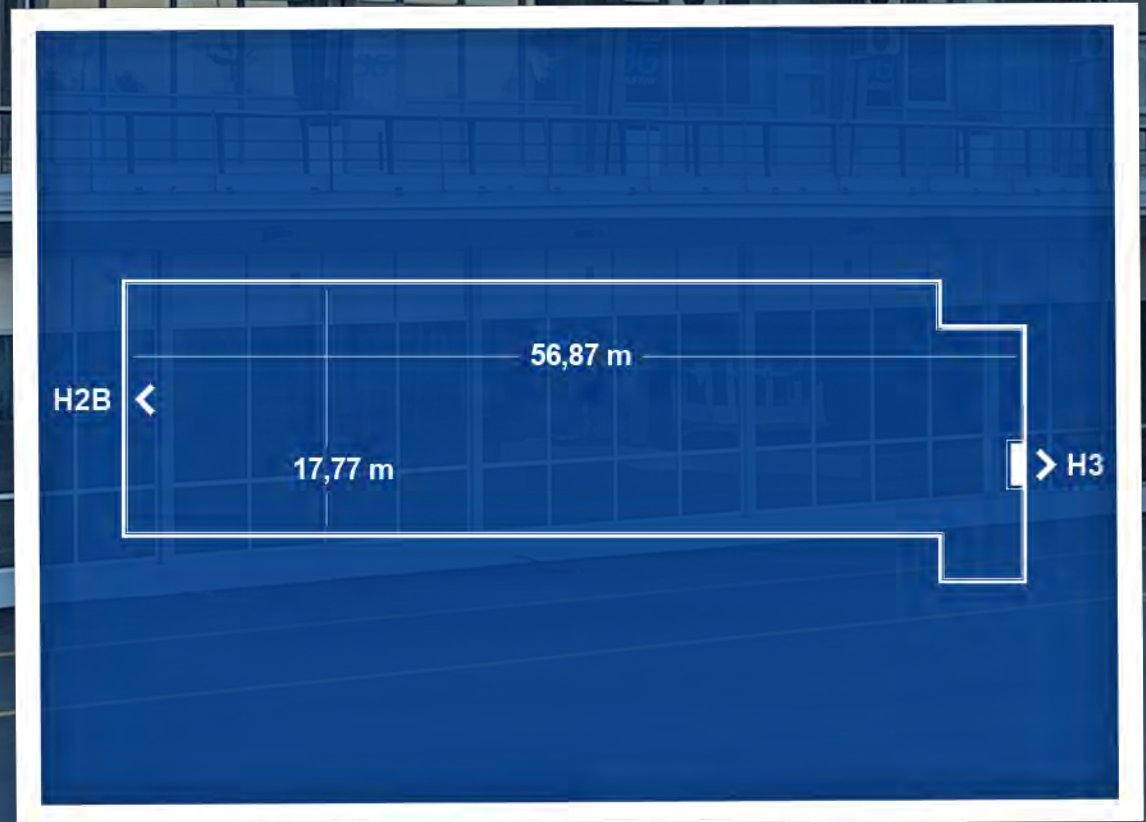



HALL 2





HALL 2

The **Hall 2** is designed as two connected square parts, each one at two levels, three levels of which are used as exhibiting space and the fourth one for warehouse and auxiliary facilities. The hall has got also a gallery above the two levels.

The total hall area is **14,427 sq. m.**, of which **9,239 sq. m.** are used as the exhibiting space. The hall is air conditioned and connected to halls 3 and 3A.

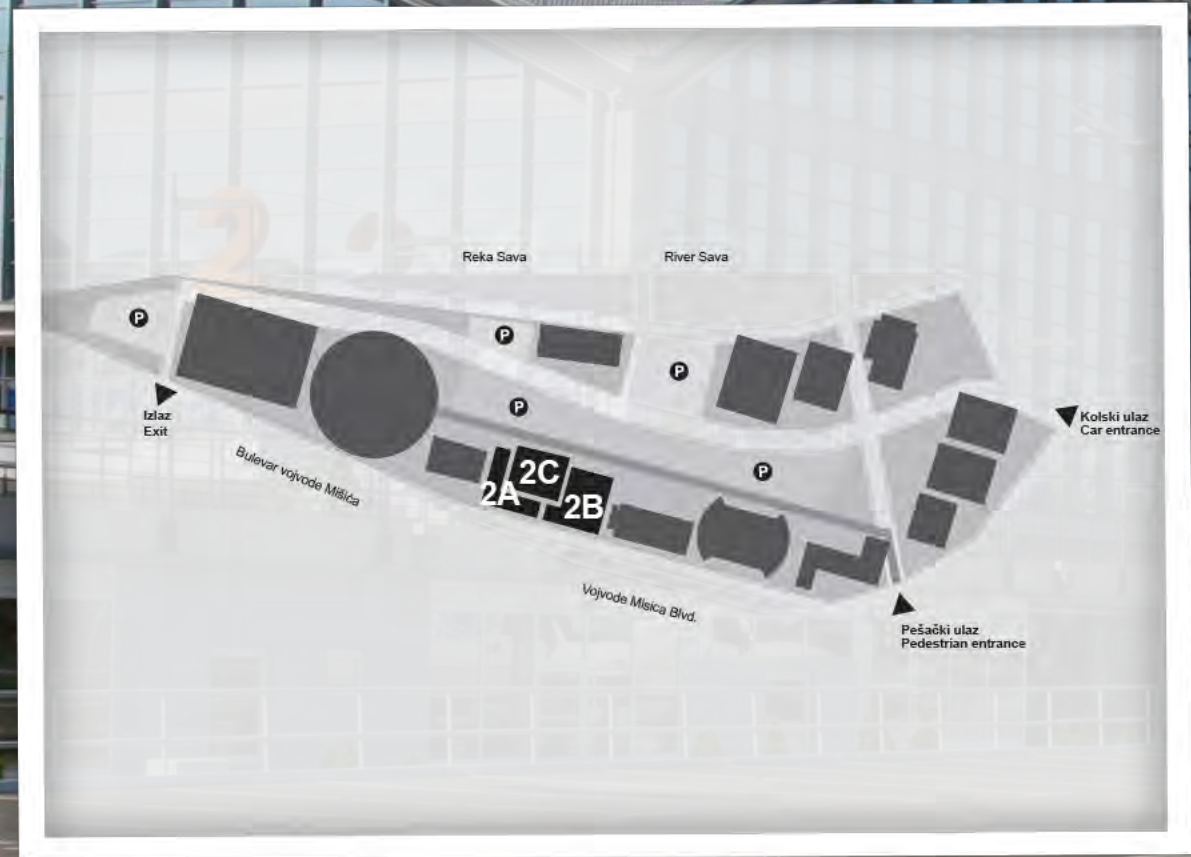



HALL 2A

Length - 55 m

Width - 53.5 m

Height - 22.6 m

Ground Floor Area - 2,921 sq. m

Pedestrian Entrances/Exits - 1

Cargo Entrance - 2 (5 x 5.80 m;
3.5 x 4.8 m)

Electricity - 220V/50Hz

Internet - Optical LAN
Network/Up to 1/1Gbs

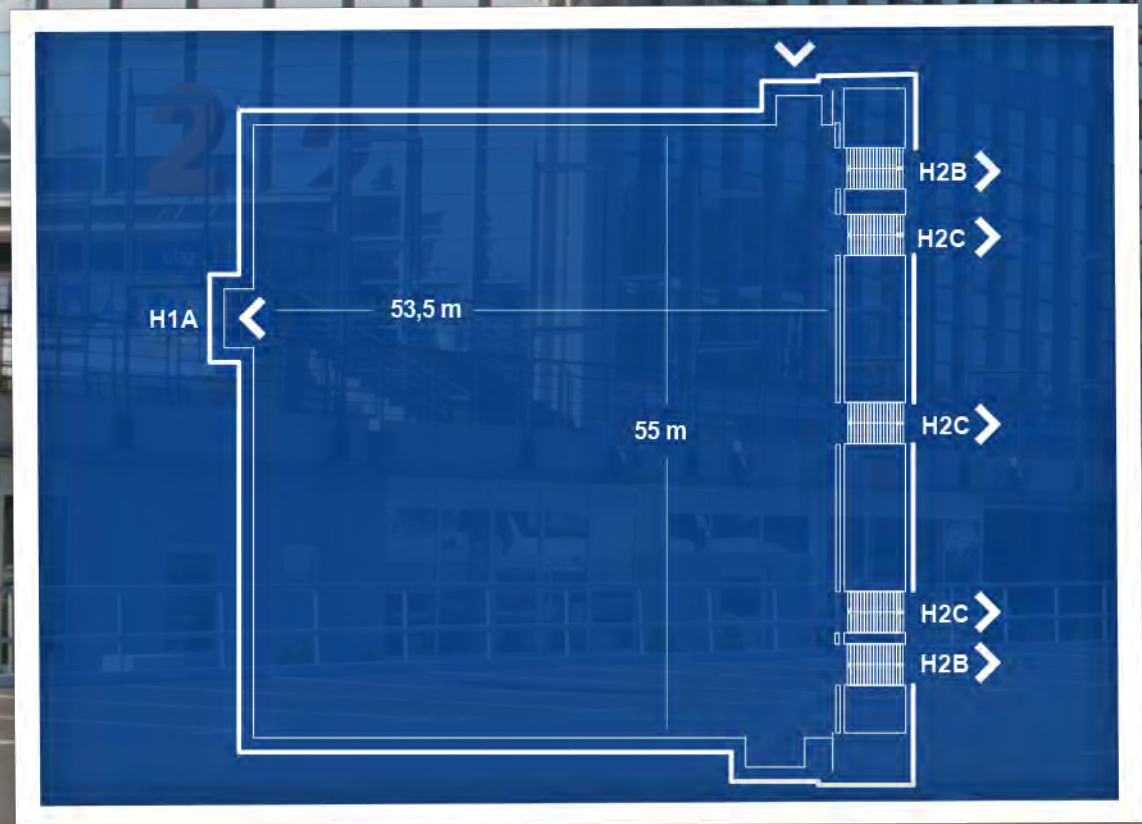



HALL 2B

Length - 73 m

Width - 55.7 m

Height - 5.17 m max

Ground Floor Area - 3,080 sq. m

Pedestrian Entrances/Exits - 2

Cargo Entrance - 1 (5.2 x 4.35 m)

Electricity - 220V/50Hz

Internet - Optical LAN
Network/Up to 1/Gbs

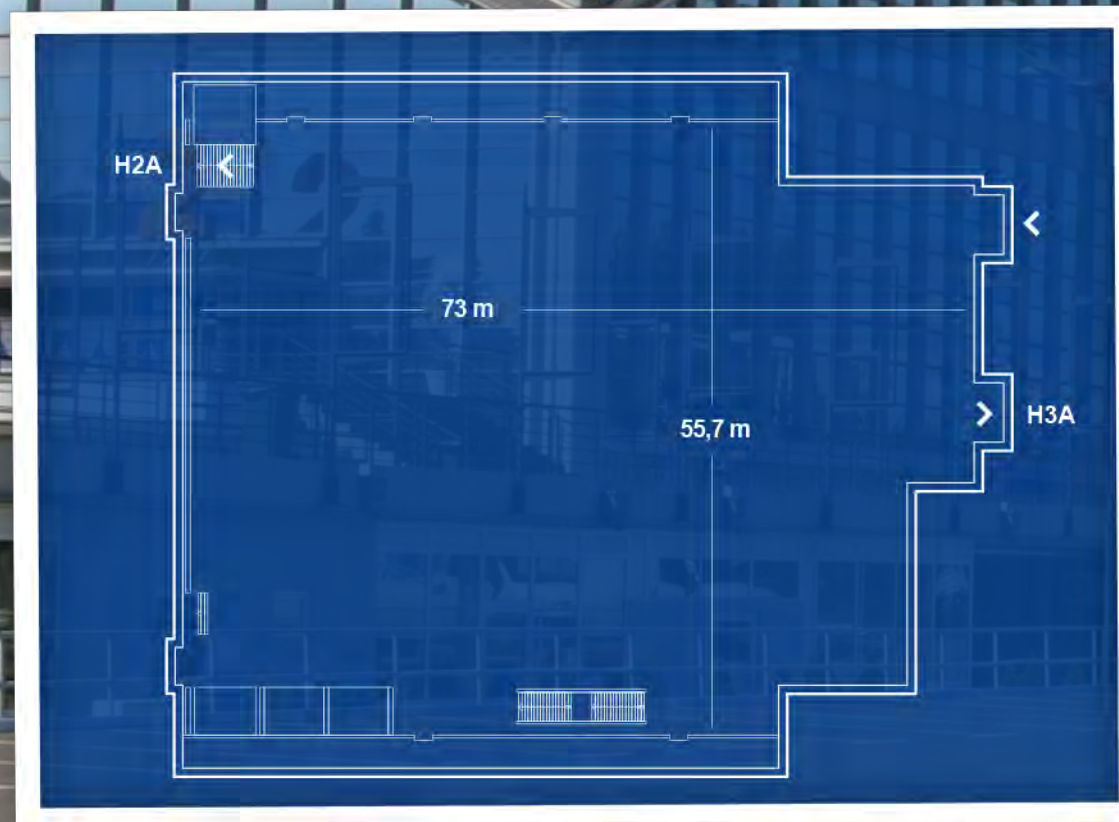



HALL 2C

Length - 56.19 m

Width - 47.5 m

Height - 19.92 m max.

Ground Floor Area - 2,626 sq. m

Pedestrian Entrances/Exits - 1

Cargo Lift - 1 (2.9 x 1.95 m)

Electricity - 220V/50Hz

Internet - Optical LAN
Network/Up to 1/1Gbs

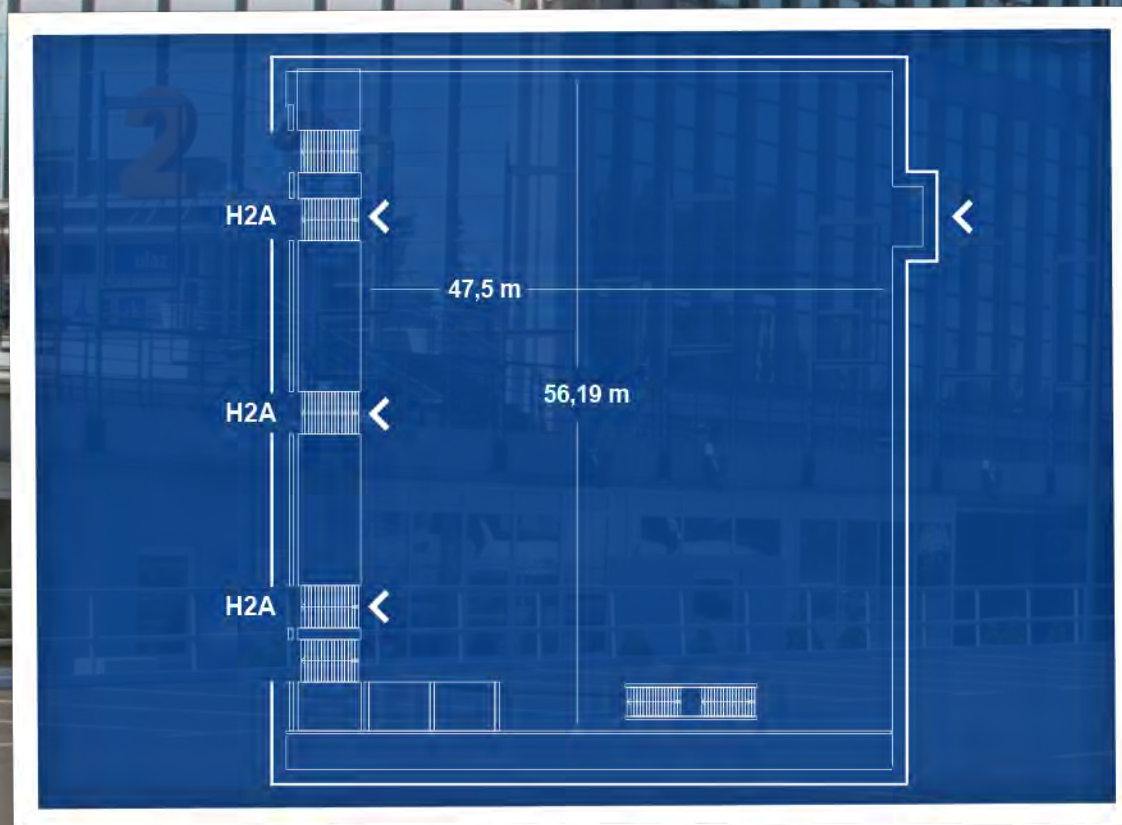



HALL 1A





HALL 1A

The **Hall 1A** has two levels. At the lower one, there are warehouse facilities, garages, offices and auxiliary facilities, whereas at the upper level the exhibiting space is constructed as two smaller facilities, connected and covered by the same roof.

The total hall area is **3,333 sq. m.**, of which **1,163 sq. m.** are used for exhibitions. The hall is air conditioned and connected to halls 1 and 2.

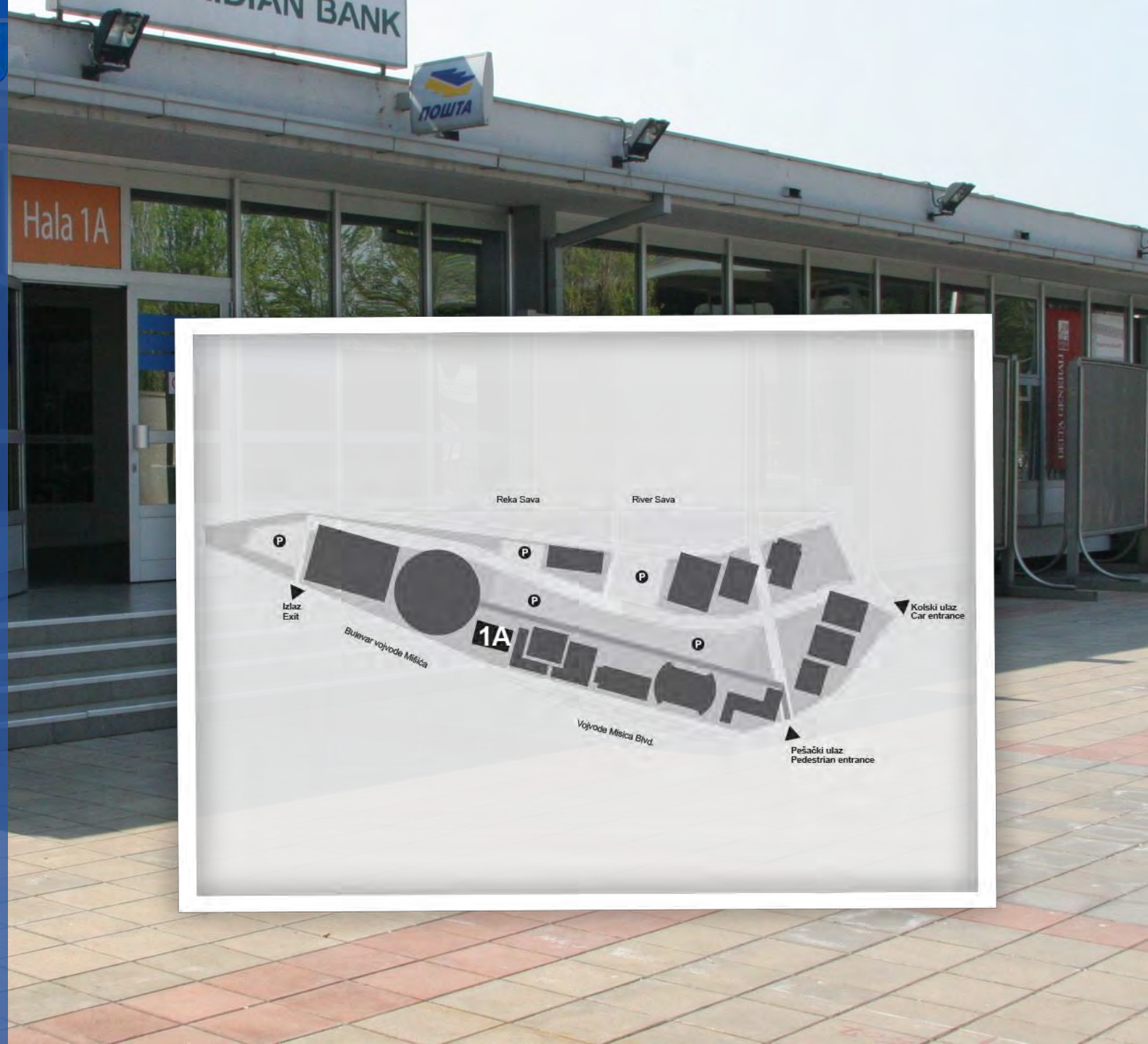



HALL 1A

Length – 44.45 m

Width – 25.7 m

Height - 2.9 m max.

Ground Floor Area - 1,163 sq. m

Entrances to Hall 1 – 2

Entrances to Hall 2 – 2

Cargo Entrance - 1 (3.5 x 2.8 m)

Electricity - 220V/50Hz

Internet - Optical LAN
Network/Up to 1/1Gbs

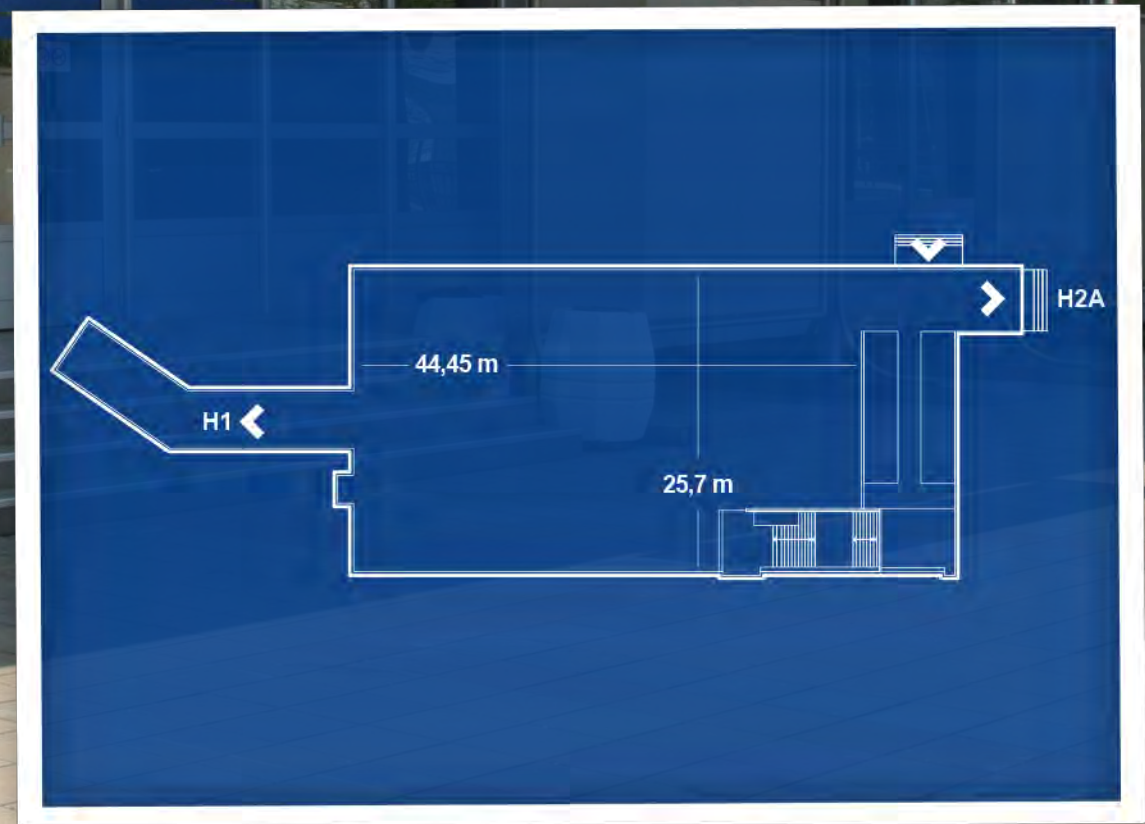
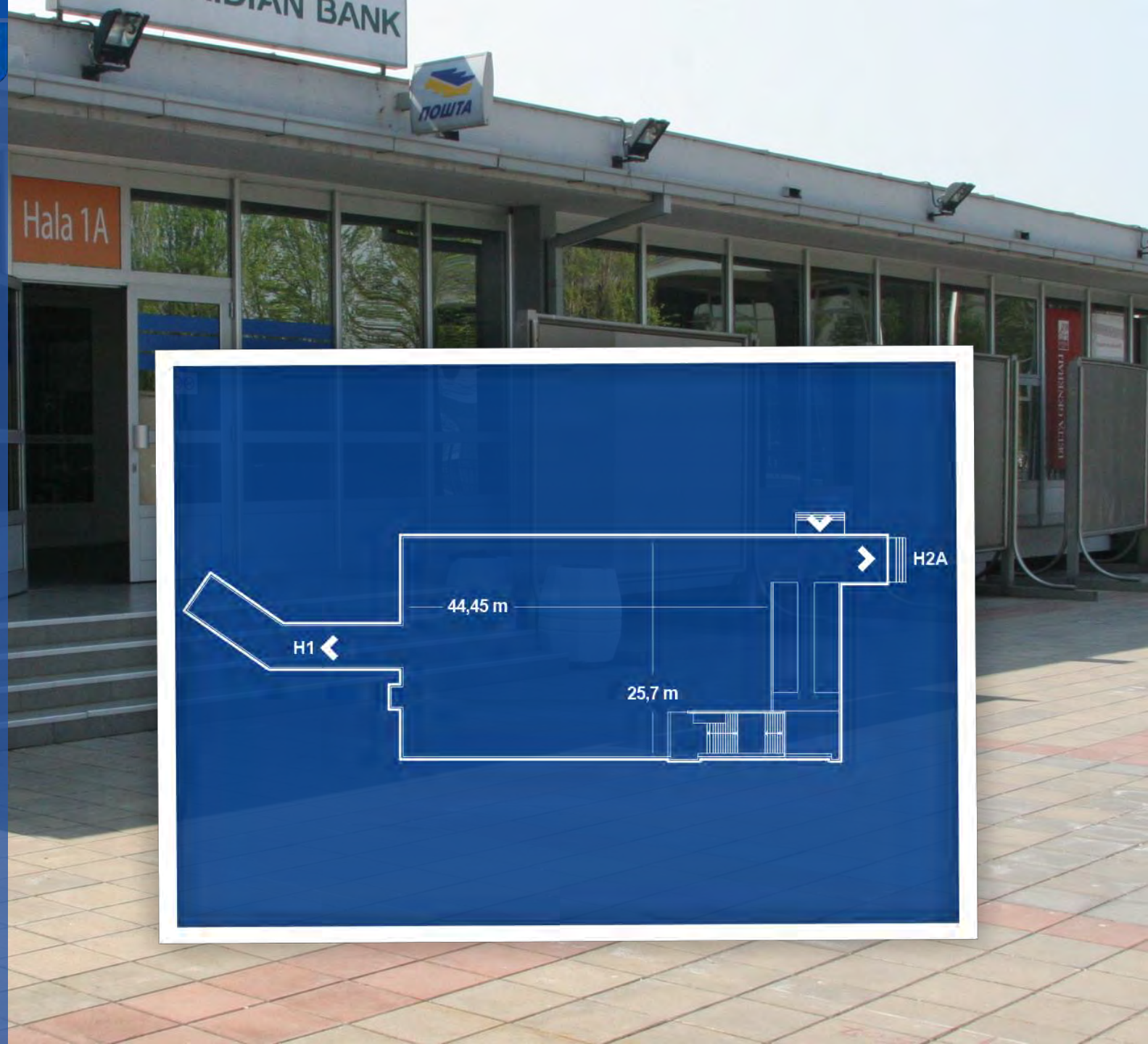



HALL 1





HALL 1

The **Hall 1** is circular in shape, covered by a dome spanning 109 m, which is at present the largest dome in the world constructed by prestressed concrete.

The hall has been constructed in levels: basement, arena, ground floor, 1st gallery, 2nd gallery and the connecting part toward the West Wing.

The hall total area is **21,280 sq. m.**, of which the exhibiting space **15,030 sq. m.** The hall is air conditioned and connected to halls 1A and 4.

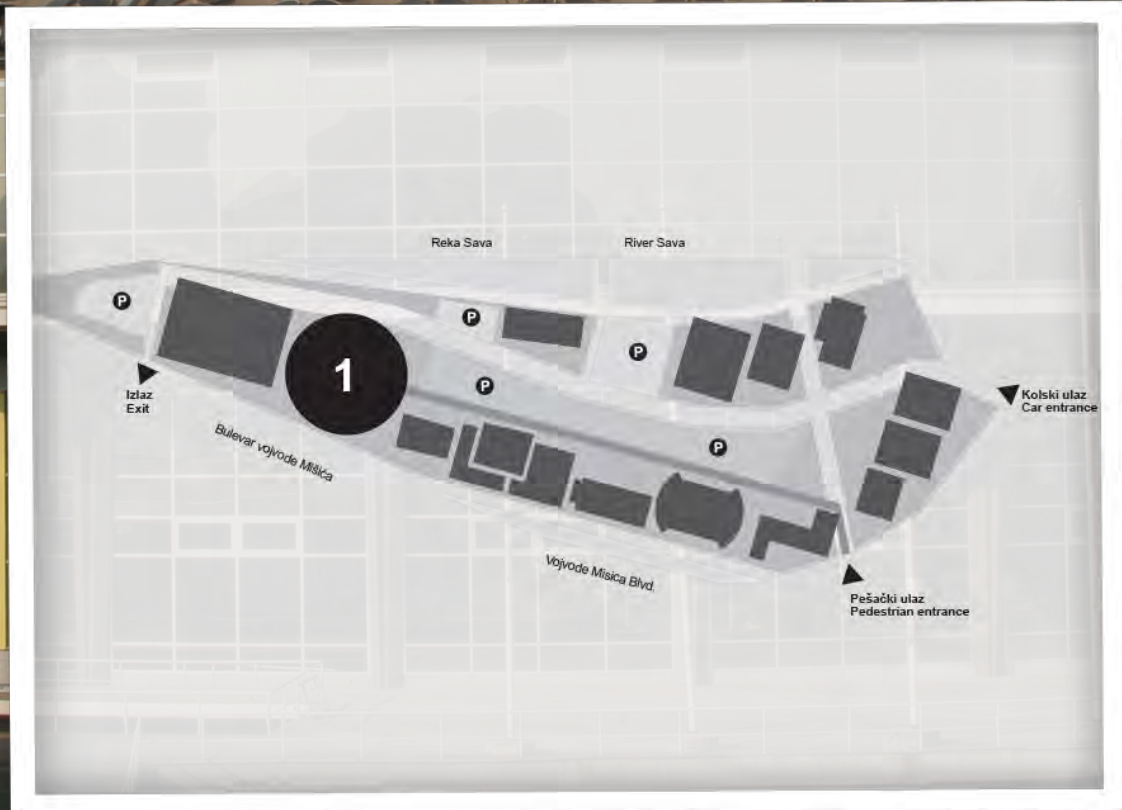
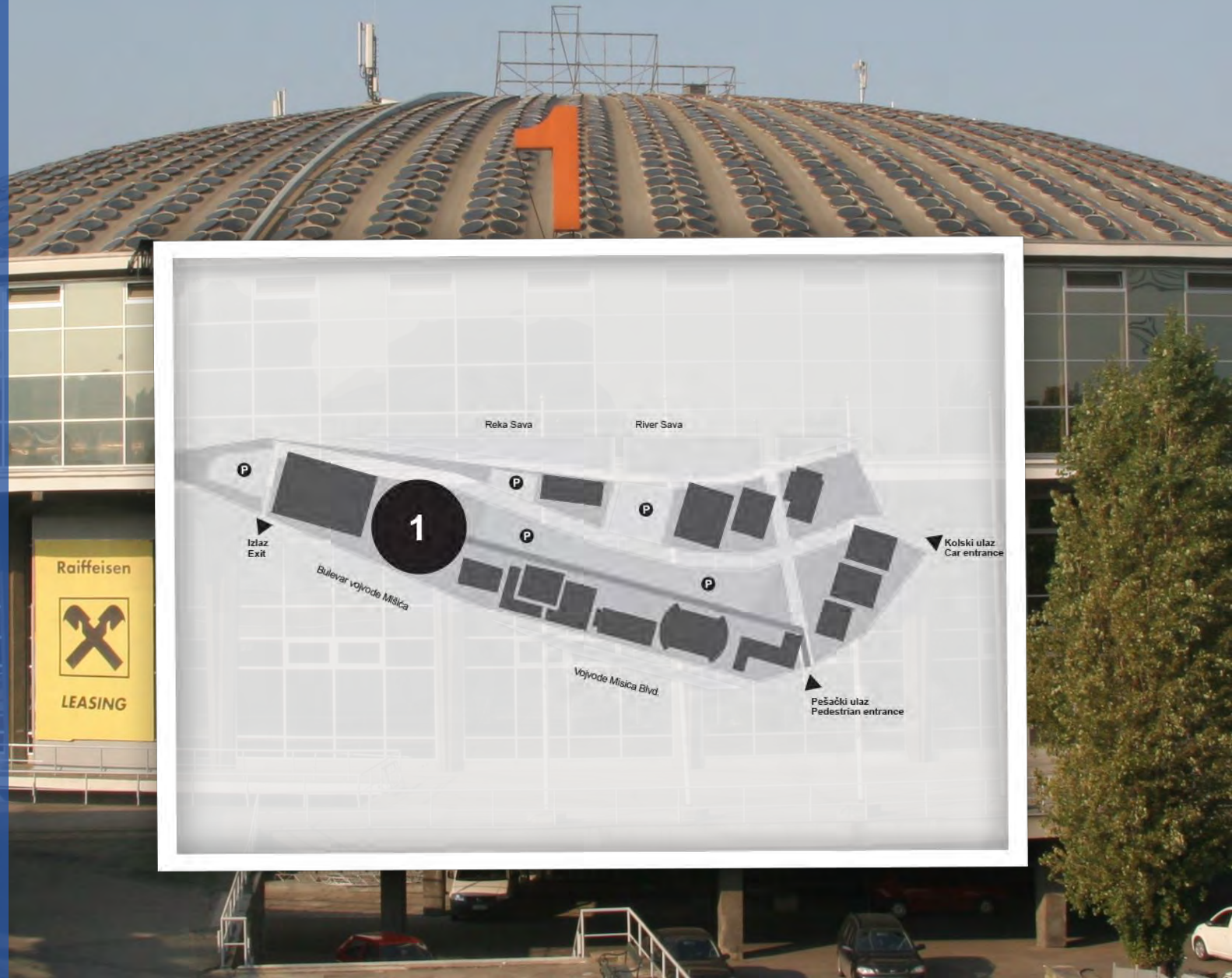



HALA 1

Arena Area – 3,648 sq. m

Arena Height – 30.78 m max

Grand floor Area – 5,640 sq. m

Grand floor Height – 3.95 m max

1st gallery Area – 2,430 sq. m

1st gallery Height – 3.4 m max

2nd gallery Area – 3,422 sq. m

2nd gallery Height – 5.3 m

Freight elevator dimensions 2.1 x 1.5 x 2.5 m,
capacity 1,500 kg

Escalator – 1

Pedestrian Entrances/Exits - 1

Cargo Entrance - 3 (4.5 x 3.95 m; 4.95 x 3.1 m; 4.55 x 3.95 m)

Electricity - 220V/50Hz

Internet - Optical LAN Network/Up to 1/1Gbs

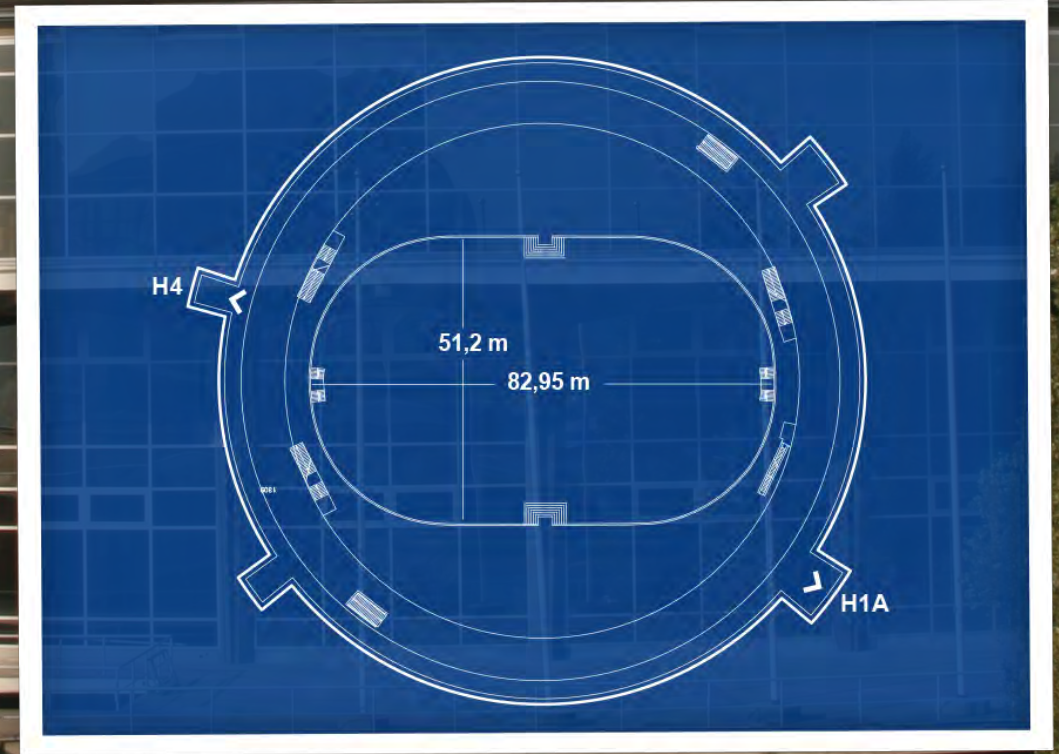
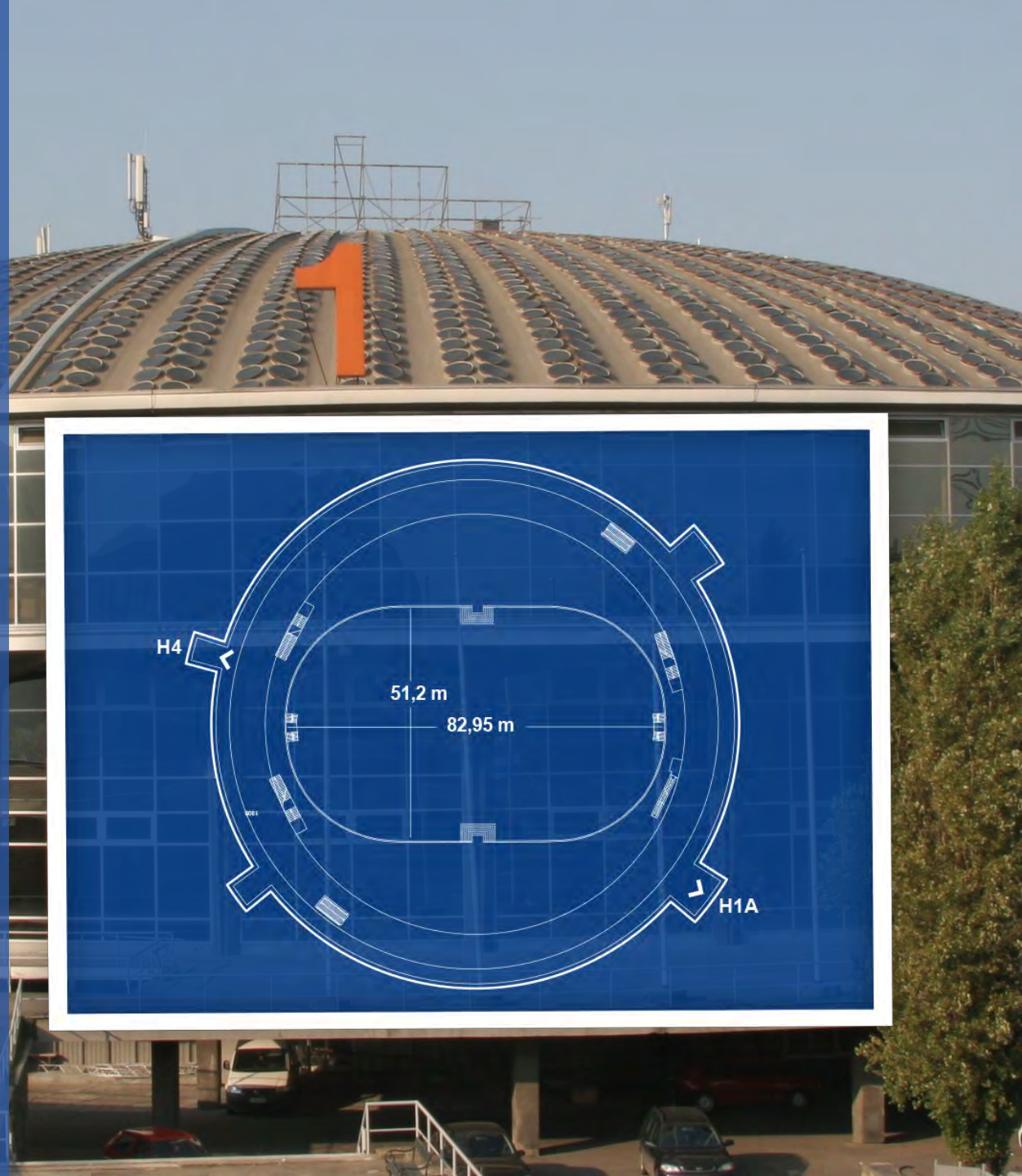



HALL 4





HALL 4

The **Hall 4** is a rectangular reinforced concrete structure. The Hall has three levels. The ground floor is used for exhibiting. The hall is air conditioned and connected to hall 1.

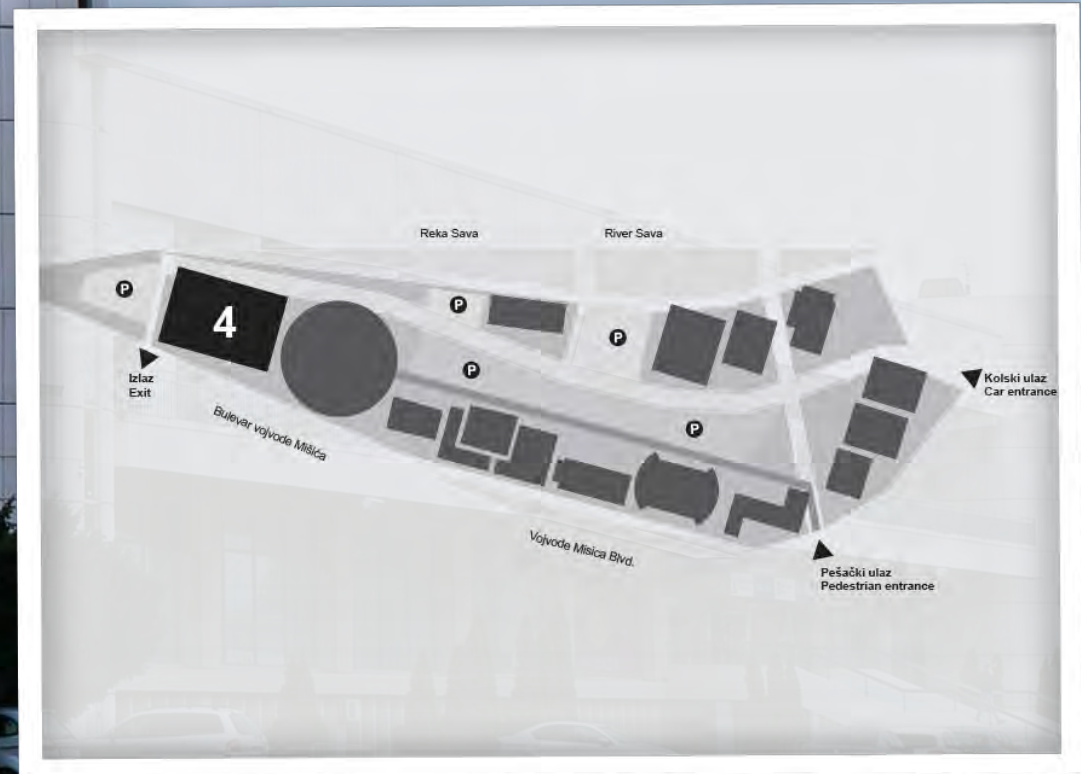



HALL 4

Length – 112 m

Width – 76 m

Ground Floor Area – 8,320 sq. m

Ground Floor Height – 8.7 m max.

Gallery Area – 3,345 sq. m

Gallery Height – 4.1 m max.

Escalator – 1

Pedestrian Entrances/Exits - 2

Cargo Entrances - 4 (3.65 x 3.8 m; 3.9 x 3.8 m; 5.75 x 3.4 m; 6.45 x 3.4 m)

Electricity - 220V/50Hz

Internet - Optical LAN Network/Up to 1/Gbs

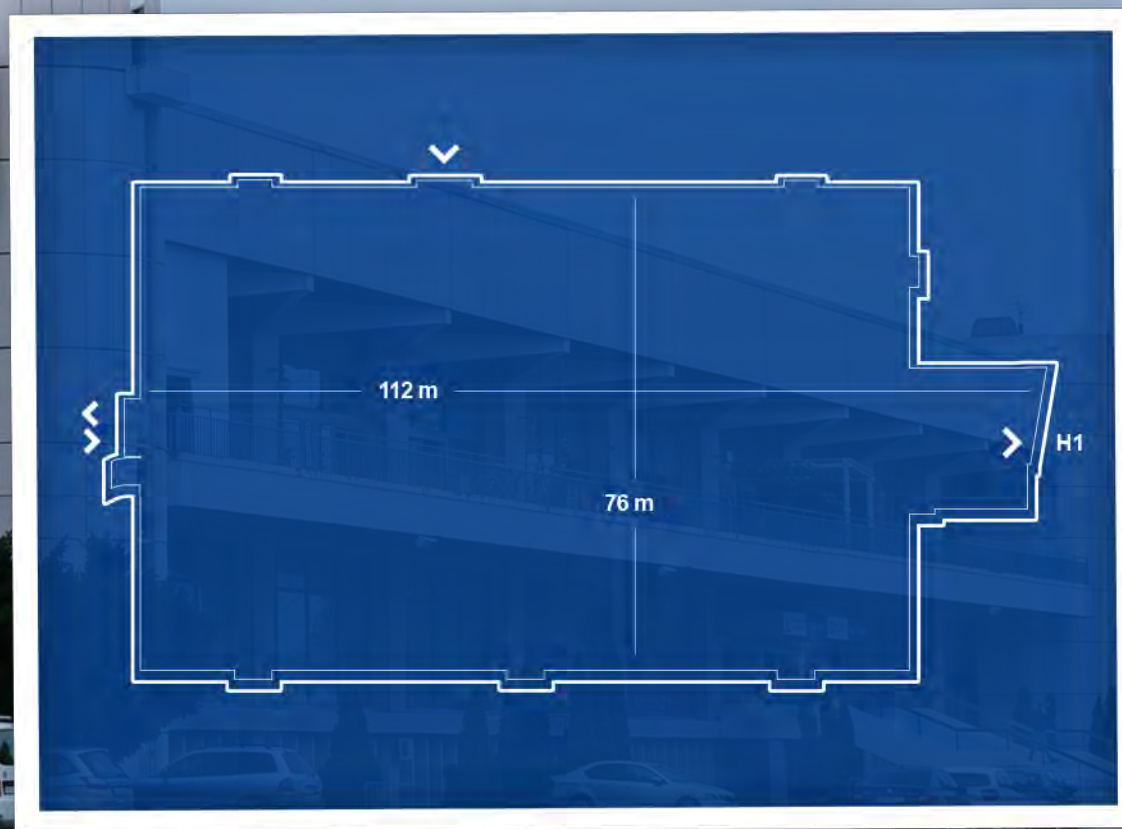



HALL 5





HALL 5

The Hall 5 is the multi-purpose facility which can feature a wide range of events such as conventions, seminars, concerts, shows, promotions, fairs, exhibitions, etc.

The Hall 5 is located opposite the Hall 3 in a succession of Halls by the river Sava embankment. Is designed as one-level rectangular facility, with support structure and roofing built of prefabricated steel elements. The hall is air conditioned.

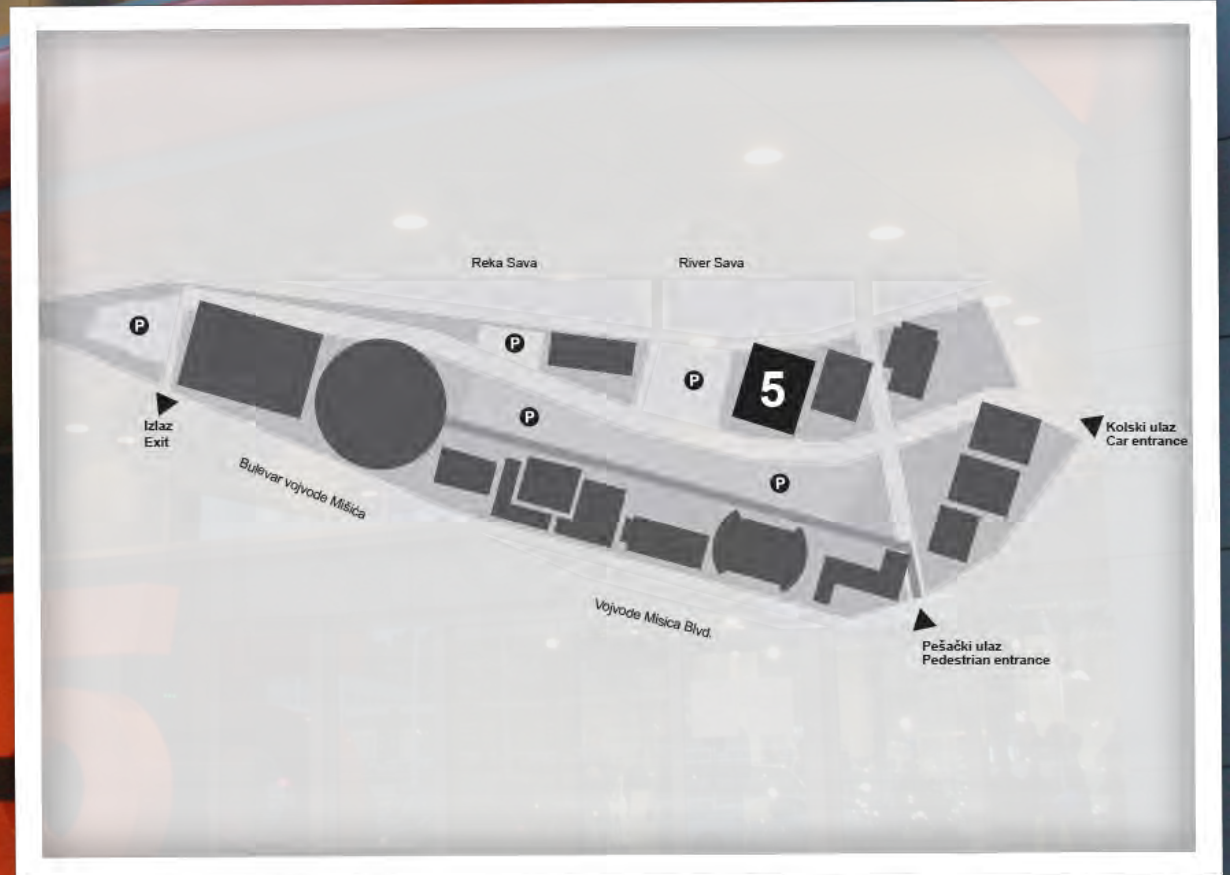



HALL 5

Length – 49.36 m

Width - 47.8 m

Ground Floor Area - 2,409 sq. m

Height - 6 m max

Pedestrian Entrances/Exits – 4
sliding

Cargo Entrance - 1 (3.9 x 5.4 m)

Electricity - 220V/50Hz

Internet - Optical LAN Network/Up
to 1/1Gbs





CONFERENCE HALLS





FESTIVE ROOM – HEAD OFFICE

- 150 SEATS
- SOUND SYSTEM
- INTERNET
- EQUIPMENT (LCD PROJECTOR, LAPTOP...)
- AIR CONDITION





CONFERENCE ROOM – HALL 4

- 300 SEATS
- SOUND SYSTEM
- INTERNET
- EQUIPMENT (LCD PROJECTOR, LAPTOP...)
- AIR CONDITION





CONFERENCE ROOM – HALL 4

- 50 SEATS
- SOUND SYSTEM
- INTERNET
- EQUIPMENT (LCD PROJECTOR, LAPTOP...)
- AIR CONDITION





PROJECT BUREAU





PROJECT BUREAU

The Project Bureau offers its decades-long experience to all those interested in a highest quality service in compliance with the standards of the world fair industry.





The expertise of our professional team, composed of experienced architects, designers and technicians, enables us to offer the widest range of solutions in modern design, both for standard and specific stands.





Experience in organizing events of all kinds of activities in Serbia has brought us knowledge that enables us to anticipate needs and offer solutions to clients that exceed their plans and expectations.





The availability of materials for constructions, electrical installations, furniture, multimedia devices, and other elements of stand construction allows us a level of work flexibility unrivaled in Serbia.





Reliability is a logical consequence and certainly the most important characteristic of our business model, and it is evidenced by the stands we have built for various events organized within the Belgrade Fair and beyond it, since the establishment of the company in 1937 until today.





The trust of our clients is extremely important to us, and for many years, we have nurtured a fruitful collaboration to mutual satisfaction with the greatest names in Serbian and international business.





We reserve special offers for the most challenging projects for clients who aim to leave a distinct impression on visitors through intriguing architectural and artistic solutions, some of which have been implemented in areas unprecedented in promotional activities in Serbia.





The originality of solutions we offer brings a prominent position and advantage in promotion to anyone seeking something different from the usual, regardless of size.





We believe that collaboration is the best way to fulfill the wishes of our clients in the process of design and construction. That's why our team is always available to listen to your requirements and find optimal solutions for all types of exhibitions and event organizations.

Туристичка организација
Краљева





We want our vision of the future to be part of your promotional activities and support to your business success.





THANK YOU!



**BELGRADE
FAIR**

WWW.SAJAM.RS

Све(т)
почиње
нашим
сусретом

БЕОГРАДСКИ
САЈАМ

